

## DIN 582 Eyenuts

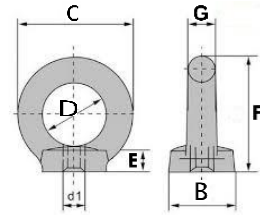

DIN 582 Eyenuts							
Thread	B	C	D	E	F	G	SWL
M6	20	36	20	8.5	36	8	70kgs
M8	20	36	20	8.5	36	8	140kgs
M10	25	45	25	10	45	10	230kgs
M12	30	54	30	11	53	12	340kgs
M14	35	63	35	13	62	14	490kgs
M16	35	63	35	13	62	14	700kgs
M20	40	72	40	16	71	16	1200kgs
M22	45	81	45	18	81	18	1500kgs
M24	50	90	50	20	90	20	1800kgs
M27	50	90	50	20	90	20	2500kgs
M30	65	108	60	25	109	24	3200kgs
M33	65	108	60	25	109	24	4300kgs
M36	75	126	70	30	128	28	4600kgs
M39	75	126	70	30	128	28	6100kgs
M42	85	144	80	35	147	32	6300kgs
M45	85	144	80	35	147	32	8000kgs
M48	100	166	90	40	168	38	8600kgs
M52	100	166	90	40	168	38	9900kgs
M56	110	184	100	45	187	42	11500kgs
M64	120	206	110	50	208	48	16000kgs

SWL Shown Are For Vertical Lift  
Will Be Supplied Untested Unless Requested

Materials	Finishes
Carbon Steel	Self Colour
Stainless Steel	BZP
Alloy Steel B7	Galvanised

INFORMATION AND DRAWINGS PROVIDED ARE REFERENCE ONLY